

PLASTIC BINDER

No.3871

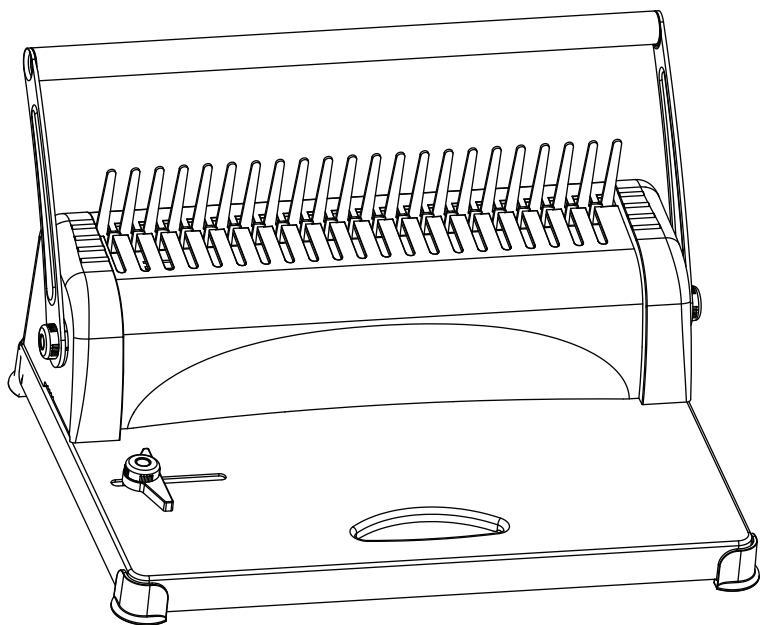

Thank you for purchasing No. 3871 rubber ring binding machine of Deli Company. The multiple functions and elegant design make the product applicable to individual use and department use. We believe that the rubber ring binding machine with complete functions will make your document binding have higher efficiency.

To make you correctly use the product and prevent the inconvenience caused to you and other people, please carefully read this manual.

Product apparent structure and the names

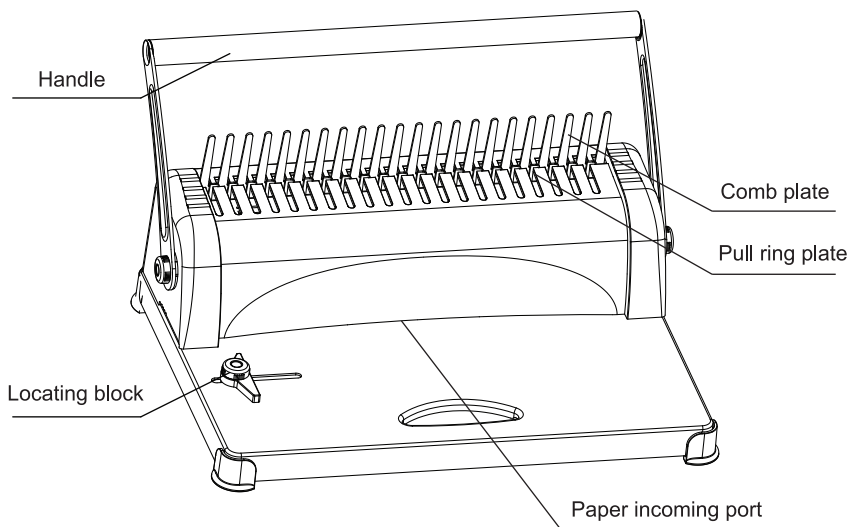
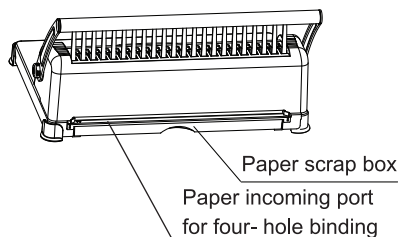

Direction for use

1. The machine is used for punching of paper and plastic sheet, and plastic clip is used for loose-leaf binding. The machine only can be used for this purpose, and please use it according to the operation instruction.
2. Before punching of the original materials, do remember to use waste paper to test whether the machine works normally.
3. Empty the waste container periodically.
4. The upper limit number for punching is 12, and this number shall not be exceeded.

1. Punching

Select the position of locating block according to the paper size. Calibrate the paper or front cover and then make it put into the paper incoming port until the bottom of the paper incoming port is reached; and then press the handle for punching.

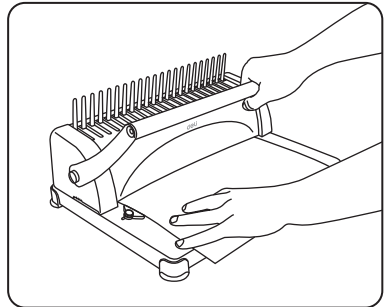

2. Binding

Select proper rubber ring according to the total thickness of the materials to be punched. Make the rubber ring applied to the comb plate and pull ring plate, and then press the handle; make the rubber ring pulled to the proper position to position it. Make the punched materials applied to the open gear of the rubber ring. Lift the handle to make the rubber ring tightened completely. Make the document taken out, and the binding is successful.

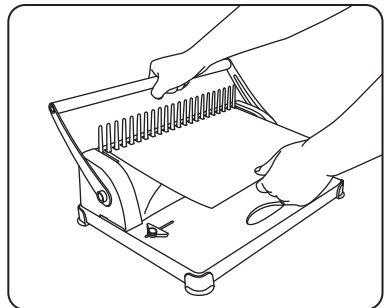

3. Four- hole binding

The binding machine has four-hole binding function. Calibrate the paper and then make it put into the paper incoming port for four- hole binding until the bottom of the channel is reached; and then press the handle for punching.

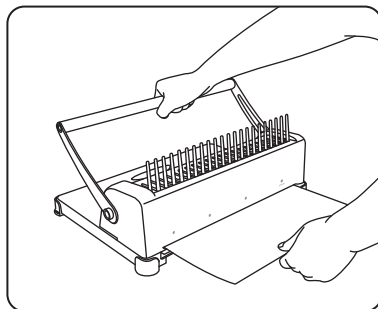

Common fault analysis and troubleshooting

Fault phenomenon	Fault cause analysis	Troubleshooting method
It is hard to press the handle when paper punching	There is paper scrap or other hard object in the paper cutting port	Take out the sundries with chipboard.
	The operation is beyond the punching capacity described in the instruction.	Operate according to the requirements of the instruction.
The punching edge distance has inclination phenomenon.	The two sides of the incoming paper are unbalanced.	The two sides of the incoming paper are unbalanced.
	There is paper scrap or other hard object in the paper cutting port.	Take out the sundries with chipboard.
The open rubber ring has inclination phenomenon.	The comb plate has deformation caused by collision.	Straighten the comb plate with a ruler.
	The draw hook of pull ring plate has deformation.	Pull the pull ring to calibrate the draw hook with hands.
Incomplete paper punching or the paper is hard to draw out.	The number of pieces of paper for punching at a time is too large.	Reduce the punching thickness of each time (based on the requirements of the instruction)
The paper cannot reach the bottom.	The paper is unserviceable and the paper edge coils.	Smoothen the paper and then re-operate.

Product parameters

Maximum punching thickness: 12 pcs of paper (70g- A4 paper)

Binding edge distance: 3mm

Distance between holes: 14.3mm

Binding specification: A4 paper or below

Maximum binding thickness: 350 pcs (δ 30mm)

deli

DELI GROUP CO.,LTD.
www.deliworld.com